

# MAINE STATE LEGISLATURE

The following document is provided by the  
**LAW AND LEGISLATIVE DIGITAL LIBRARY**  
at the Maine State Law and Legislative Reference Library  
<http://legislature.maine.gov/lawlib>



Reproduced from scanned originals with text recognition applied  
(searchable text may contain some errors and/or omissions)

1 FIRST REGULAR SESSION  
2

3 ONE HUNDRED AND ELEVENTH LEGISLATURE  
4

5 Legislative Document

No. 1333

6  
7 H.P. 1008

House of Representatives, March 25, 1983

8 Submitted by the Department of Conservation pursuant to Joint Rule 24.  
9 Referred to the Committee on Energy and Natural Resources. Sent up for  
concurrence and ordered printed.

EDWIN H. PERT, Clerk

10 Presented by Speaker Martin of Eagle Lake.

Cosponsors: Senator McBreairty of Aroostook and Representative  
Anderson of Stockholm.

11  
12 STATE OF MAINE  
13

14 IN THE YEAR OF OUR LORD  
15 NINETEEN HUNDRED AND EIGHTY-THREE  
16

17 RESOLVE, Authorizing the Exchange of  
18 Certain Public Lands.  
19

20 Director of Bureau of Public Lands authorized to  
21 consummate the exchange of certain public, domain,  
22 lands. Resolved: That the Director of the Bureau of  
23 Public Lands is authorized to consummate an exchange  
24 of land in the Town of New Sweden between the State  
25 of Maine and Richard and Gloria Seigars of New Swe-  
26 den. Land received by the State in this trade will  
27 be managed under the authority of Title 12, section  
28 554.

29 In accordance with the provisions of Title 30,  
30 section 4169, there has been public notification of  
31 the proposed exchange. No request for a public meet-  
32 ing has been received.

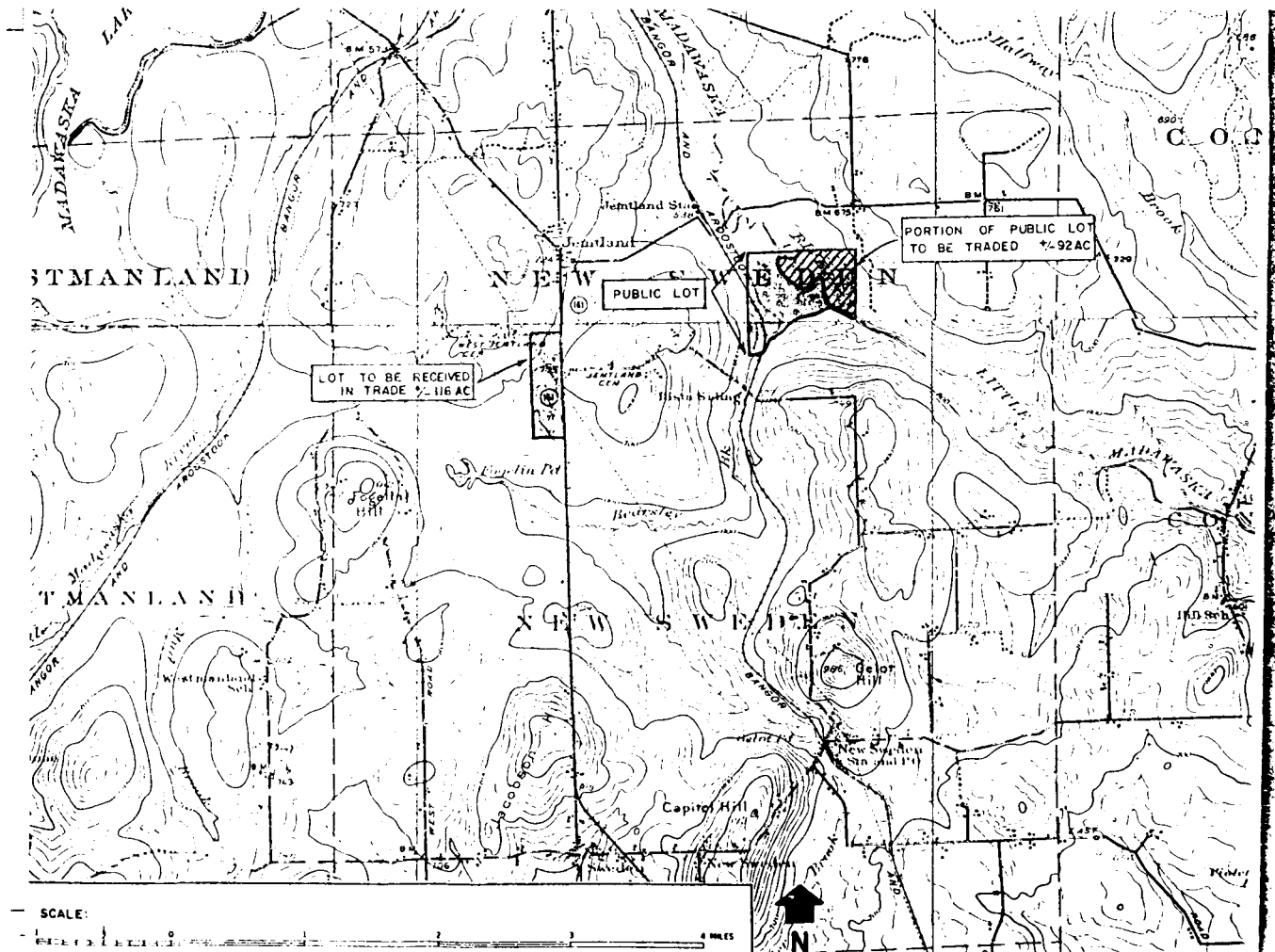

1

STATEMENT OF FACT

2

This resolve authorizes an exchange of 92 acres, more or less, of public domain land in return for 116 acres, more or less, of neighboring land owned by Richard and Gloria Seigars, as indicated on the attached map. The purpose of the exchange is to resolve problems of access associated with that portion of the public domain parcel located on the northeast side of the Little Madawaska River. Attempts to negotiate a right-of-way from existing transportation routes across abutting private property to the public domain parcel have not been successful.

3

4

5

6

7

8

9

10

11

12

13

14

The trade parcel to be received by the State is forested, suitable for management and located along a major travel route. The Board of Selectmen, Town of New Sweden, expressed its approval of the proposed exchange in a letter to the bureau, dated September 20, 1982.

15

16

17

18

19

20

2877031683